

## Set Up instructions | 10 ft Vertical Curve TensionLite

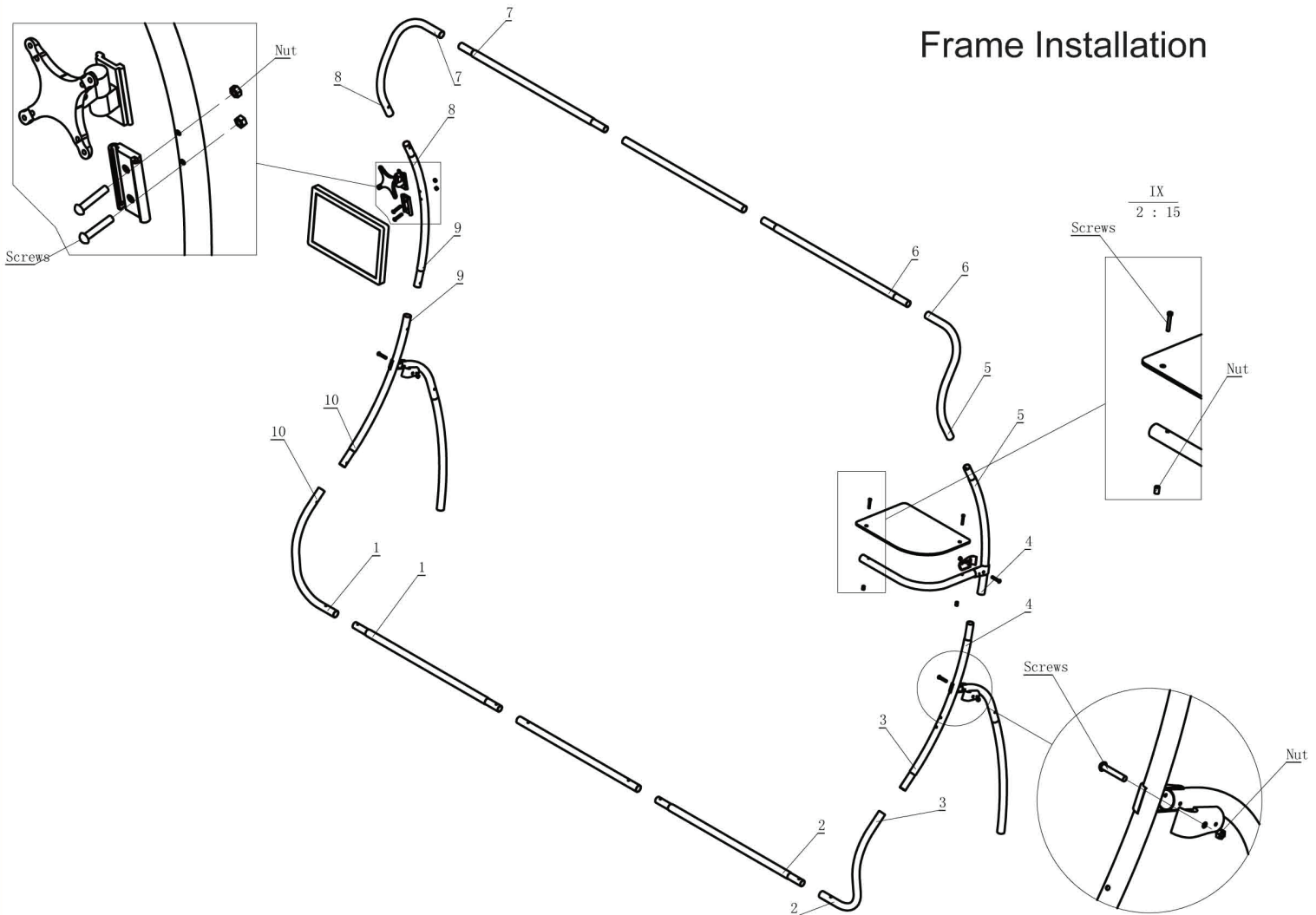

## Set Up instructions | 10 ft Vertical Curve TensionLite

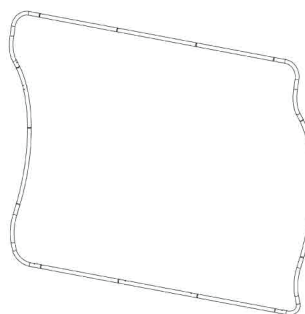

### STEP 1:

Connect all the pipes together \ according to the sticker number on each pipe. Make sure it is the same sticker number before you join the pipes. (Do not attach the legs yet).

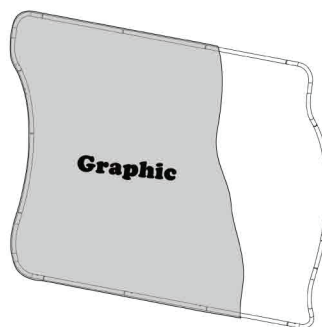

### STEP 2:

Put the graphic on the frame just like you put a pillowcase on a pillow. Zip up the graphic holding together the zipper sides.

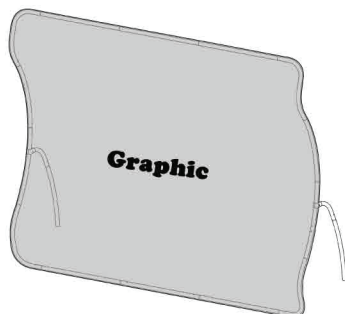

### STEP 3:

Install the legs.

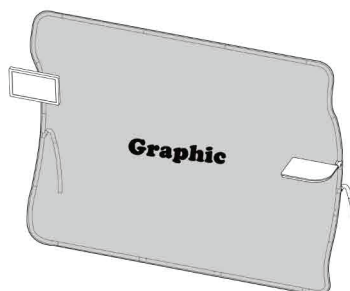

### STEP 4:

Attach the monitor mounts, shelf and lights. (note: over-tightening the lights may result in damage to the graphic print)